

Issue 11

In this issue, we will attach the Exhaust Manifold to the engine assembled up to Issue 10, and also connect the Actuator's Vacuum Hose.

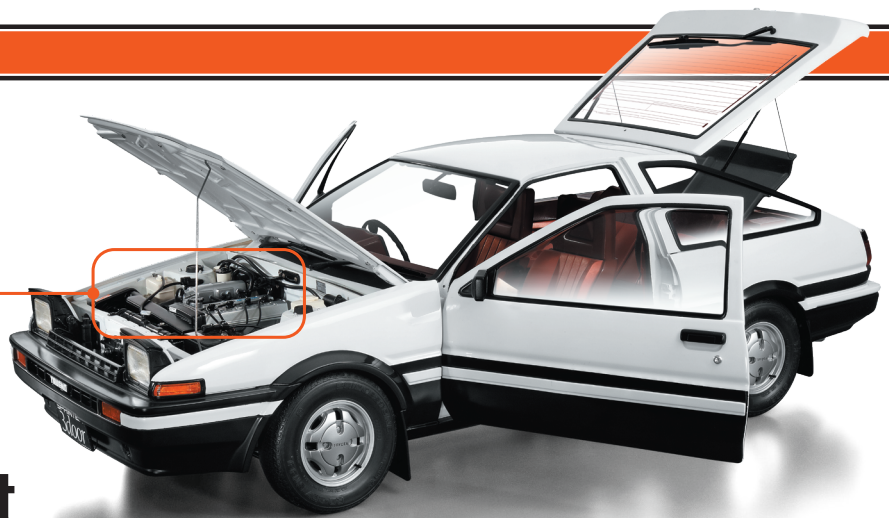

Attach the Exhaust Manifold

※ In this guide "Left" or "(L)", and "Right" or "(R)", refer to the direction as viewed from the driver's seat.

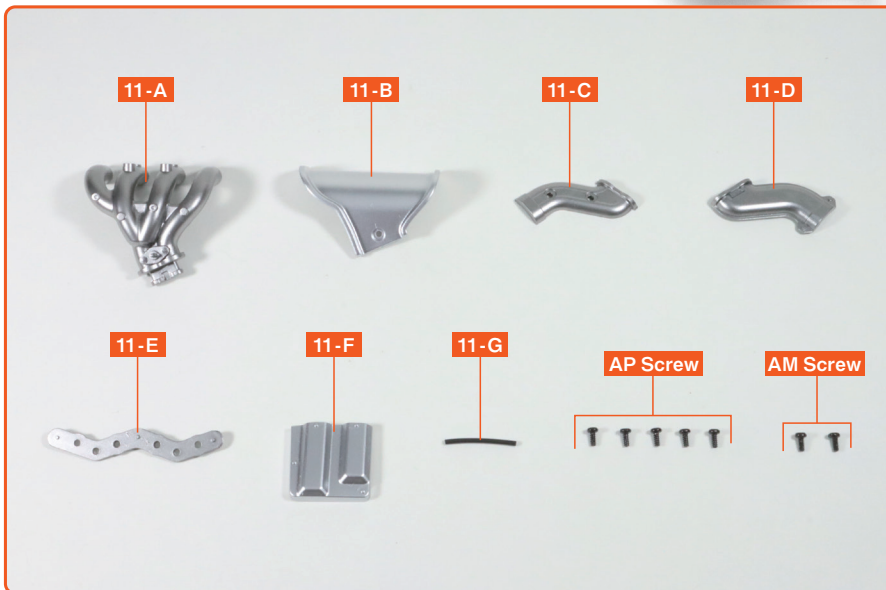

11-A Exhaust Manifold

11-B Exhaust Manifold Insulator 1

11-C Exhaust Front Pipe Upper (1)

11-D Exhaust Front Pipe Upper (2)

11-E Exhaust Manifold Gasket

11-F Exhaust Manifold Insulator 2

11-G Actuator Vacuum Hose

AP Screw (1.7×4 mm) ×5+Spare

AM Screw (1.7×4 mm) ×2+Spare

View the follow-along video



※Due to the model's design, the shapes of some parts may differ from those of the real vehicle.

step 1 Attach the Exhaust Manifold

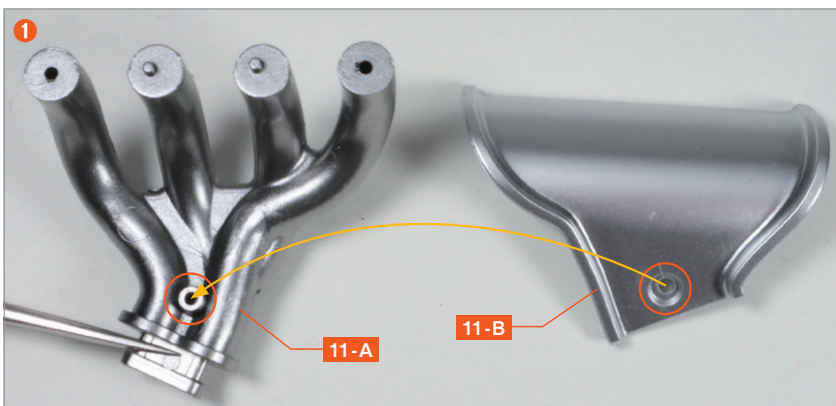

Align the bolt hole on the back of the **Exhaust Manifold 11-A** with the bolt hole of the **Exhaust Manifold Insulator 1 11-B**.

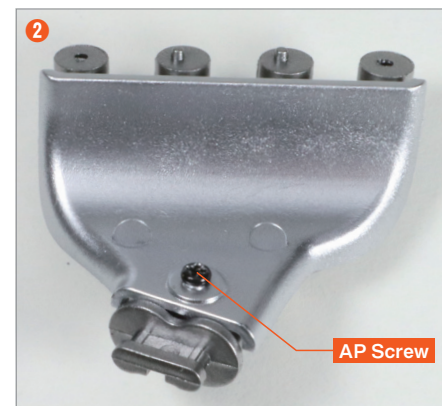

While holding **11-A** and **11-B** so their bolt holes stay aligned, fasten them with an **AP screw**.

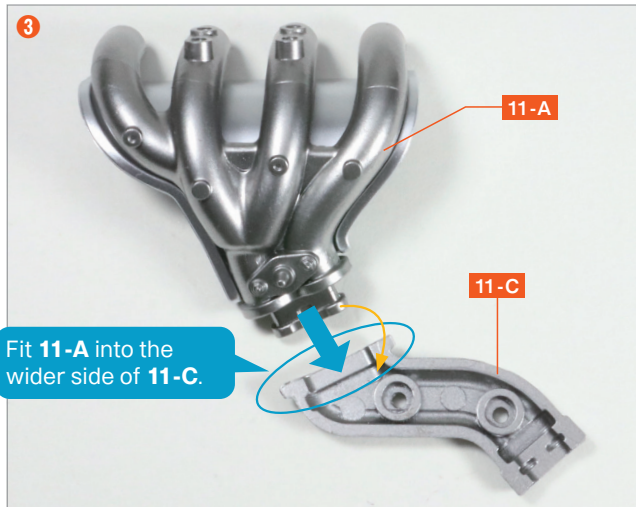

Turn the **Exhaust Manifold** assembled in step 2 upside down, and fit the base of **11-A** into the groove of the **Exhaust Front Pipe Upper (1) 11-C**.

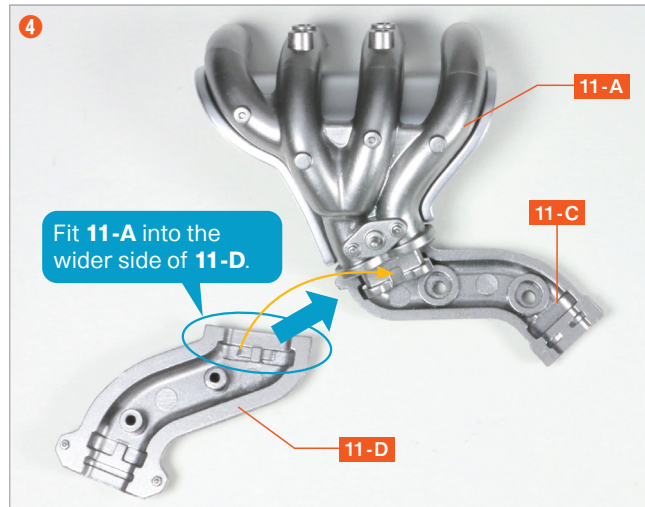

Next, place the **Exhaust Front Pipe Upper (2) 11-D** over it. Fit the base of **11-A** so that it is held between the grooves of **11-C** and **11-D**.

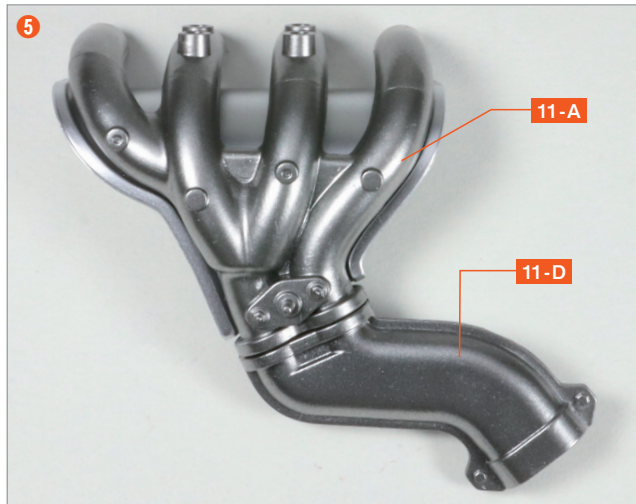

After sandwiching the base of **11-A**, **11-C** and **11-D** should now be aligned together.

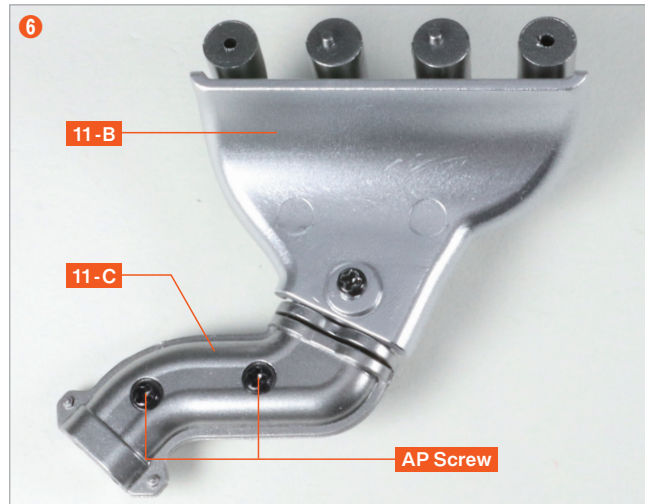

Flip the assembly over carefully so that **11-C** and **11-D** do not shift, align the screw holes, and fasten the two points with **AP screws**.

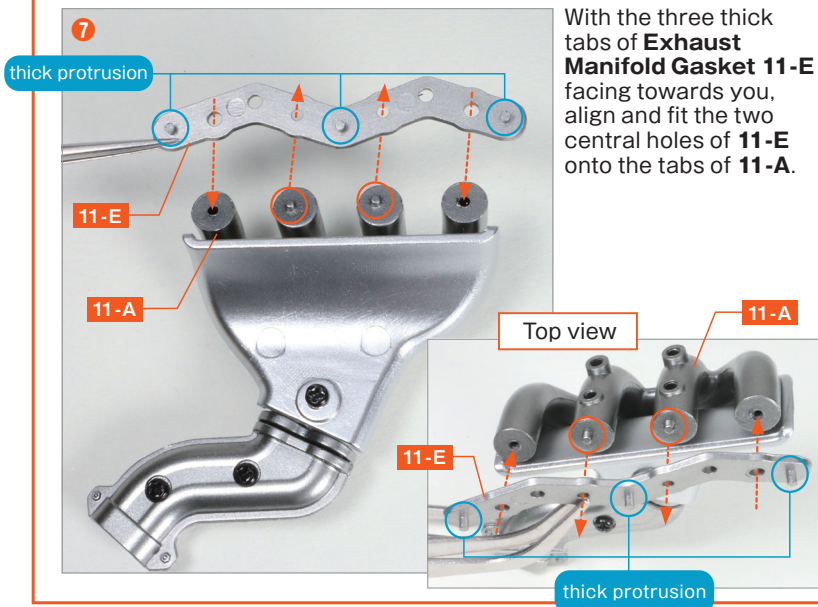

With the three thick tabs of **Exhaust Manifold Gasket 11-E** facing towards you, align and fit the two central holes of **11-E** onto the tabs of **11-A**.

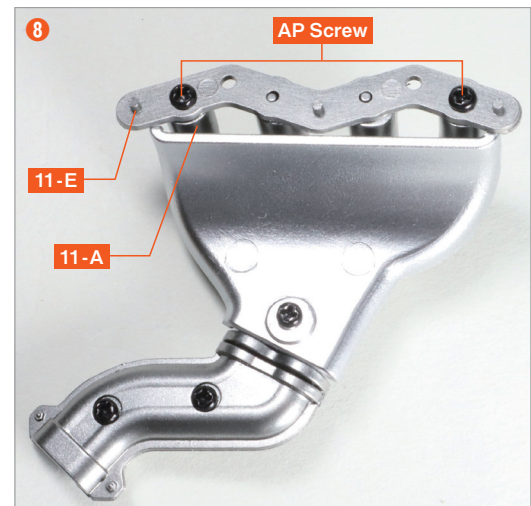

Align the screw holes of **11-E** and **11-A**, then fasten the two points with **AP screws**.

Step complete

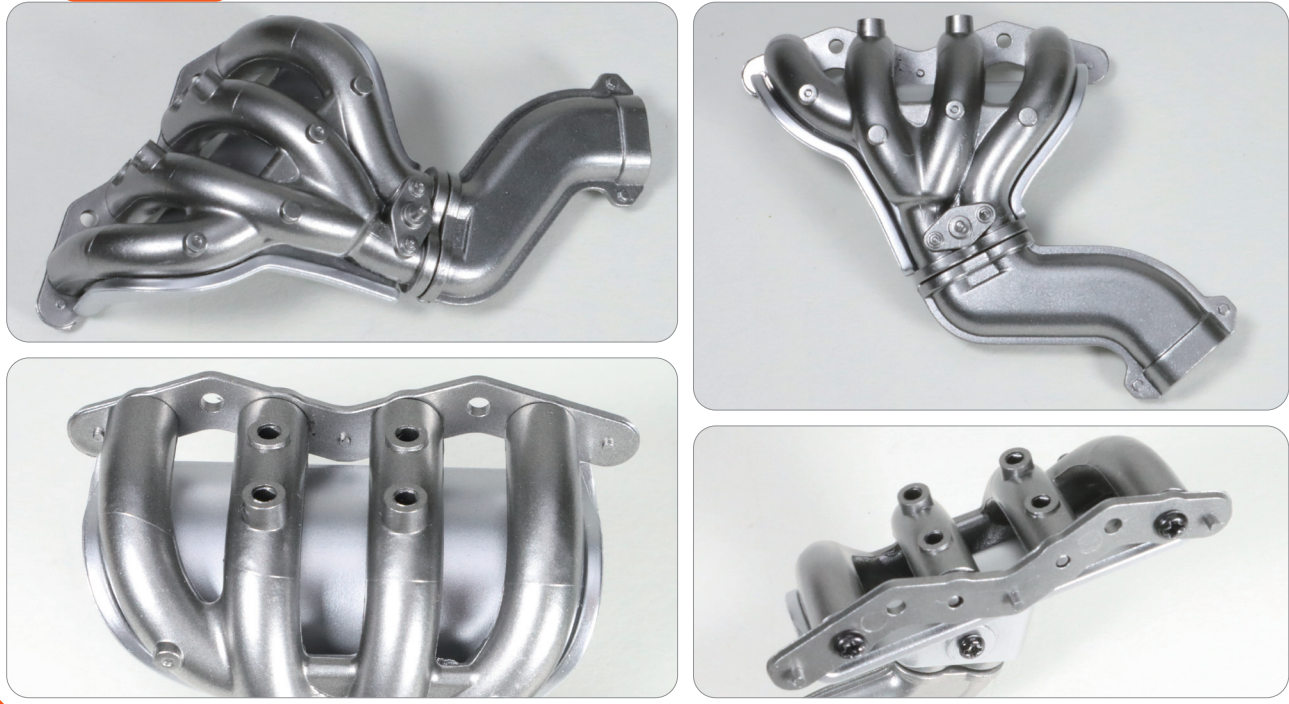

step 2 Attach the Exhaust Manifold to the Engine

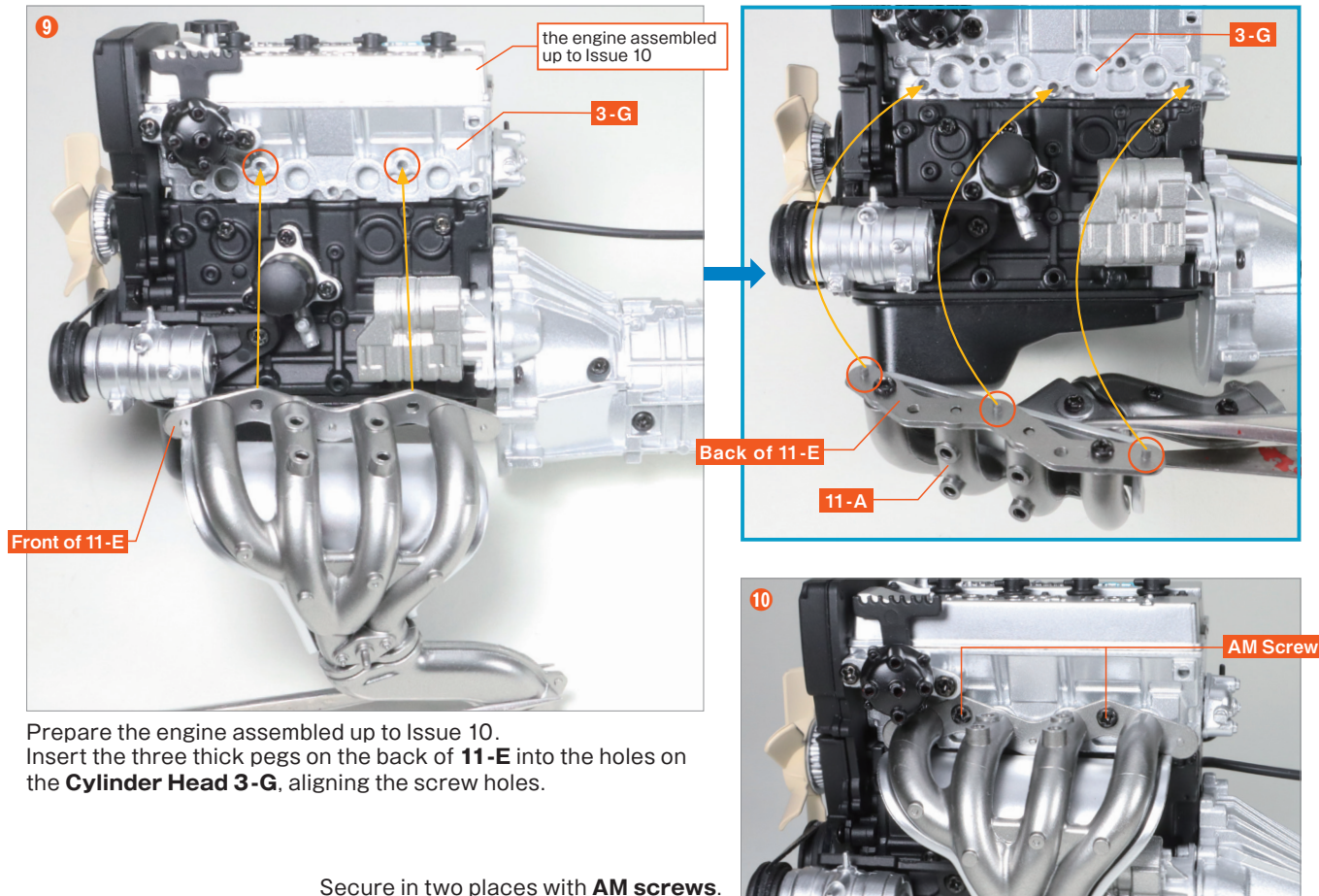

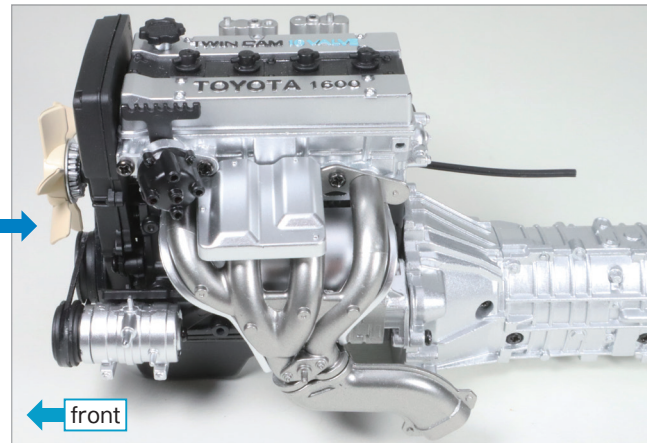
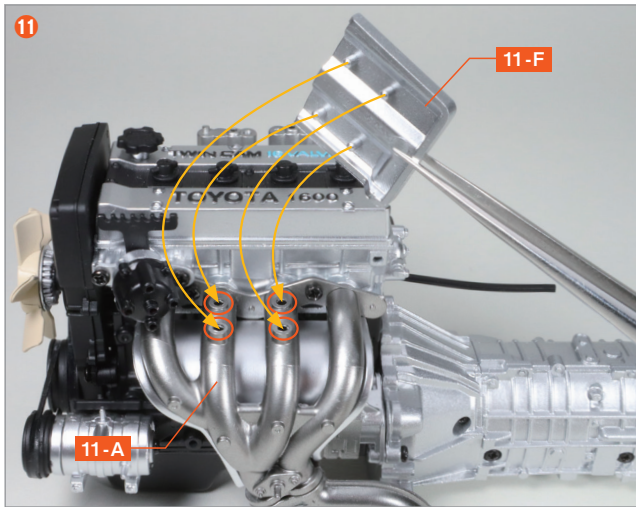

Insert the four pegs on the back of **Exhaust Manifold Insulator 2 11-F** into the corresponding holes on **11-A**.

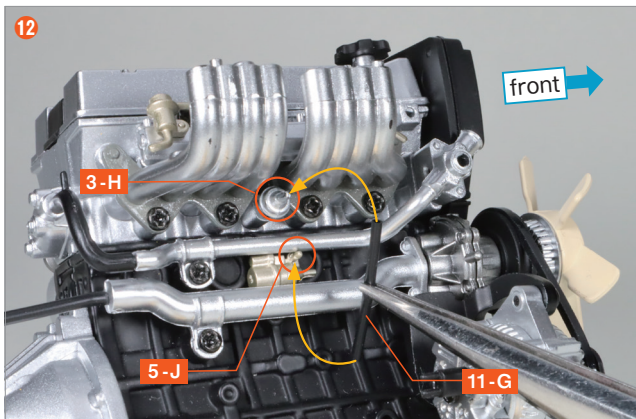

Turn the engine over, then push each end of **Actuator Vacuum Hose 11-G** onto the peg of the **Vacuum Control Valve 5-J** and the peg of the **Actuator 3-H**, respectively.

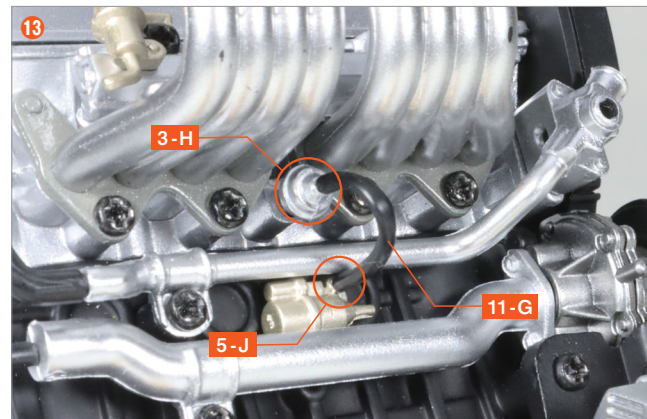

Connect **3-H** and **5-J** with **11-G**, as shown.

Complete

The assembly for Issue 11 is complete. The Exhaust Manifold has been attached to the left side of the engine, giving you a clear view of the exhaust system layout. In Issue 12, we will install the engine's most distinctive feature, the T-VIS intake control system.

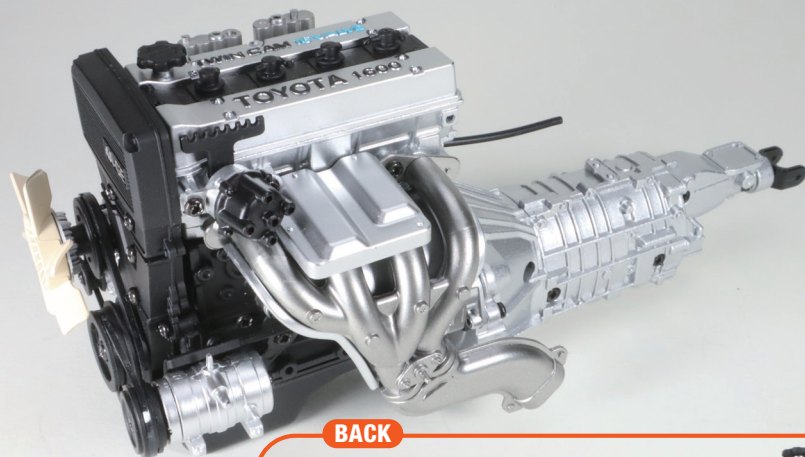

BACK

